

# INDUSTRIAL FITTINGS

- CLAW COUPLING..... 62-63
- GROUND JOINT SEAL..... 64-65
- CAM & GROOVE ..... 66-71
- COMBINATION NIPPLE..... 72
- HAMMER LUG UNION ..... 73
- DRY-DISCONNECT AND SAFETY BREAK-AWAY COUPLING ..... 74
- FLANGED FITTING ..... 75-76
- BUILT-IN FITTING..... 77
- COMPOSITE HOSE FITTING..... 78-81



## TYPE B CLAW COUPLING (U.S. TYPE)

Hose shank - Gasket Included



Item Code	Part Number	Hose ID in	Hose ID mm	Claw Distance Internal mm	Claw Distance External mm	Material	Note
2303335	I919K300-010041	3/8	10	41	62	MALLEABLE IRON	
2302919	I919K300-013041	1/2	13	41	62	MALLEABLE IRON	
2302920	I919K300-019041	3/4	19	41	62	MALLEABLE IRON	
2302921	I919K300-025041	1	25	41	62	MALLEABLE IRON	
2303366	I919K300-032041	1 1/4	32	41	62	MALLEABLE IRON	4 LUG TYPE
2303367	I919K300-038041	1 1/2	38	41	62	MALLEABLE IRON	4 LUG TYPE
2303368	I919K300-051041	2	51	41	62	MALLEABLE IRON	4 LUG TYPE
2306780	I319K300-013041	1/2	13	41	62	S/S 316	
2306781	I319K300-019041	3/4	19	41	62	S/S 316	
2306782	I319K300-025041	1	25	41	62	S/S 316	

TO ASSEMBLE THE INSERT USE CLAW CLAMP OR CRIMPING RING

## TYPE B CLAW COUPLING (U.S. TYPE)

Male NPT - Gasket Included



Item Code	Part Number	Thread in	Thread type	Claw Distance Internal mm	Claw Distance External mm	Material
2303344	I9A9K228-041013	1/4	NPT	41	62	MALLEABLE IRON
2303345	I9A9K228-041017	3/8	NPT	41	62	MALLEABLE IRON
2302922	I9A9K228-041021	1/2	NPT	41	62	MALLEABLE IRON
2302923	I9A9K228-041027	3/4	NPT	41	62	MALLEABLE IRON
2302924	I9A9K228-041034	1	NPT	41	62	MALLEABLE IRON
2306784	I3A9K228-041021	1/2	NPT	41	62	S/S 316
2306785	I3A9K228-041027	3/4	NPT	41	62	S/S 316
2306786	I3A9K228-041034	1	NPT	41	62	S/S 316

## TYPE B CLAW COUPLING (U.S. TYPE)

Female NPT - Gasket Included



Item Code	Part Number	Thread in	Thread type	Claw Distance Internal mm	Claw Distance External mm	Material	Note
2303354	I9A9K328-041013	1/4	NPT	41	62	MALLEABLE IRON	
2303355	I9A9K328-041017	3/8	NPT	41	62	MALLEABLE IRON	
2302925	I9A9K328-041021	1/2	NPT	41	62	MALLEABLE IRON	
2302926	I9A9K328-041027	3/4	NPT	41	62	MALLEABLE IRON	
2302927	I9A9K328-041034	1	NPT	41	62	MALLEABLE IRON	
2303372	I9A9K328-041042	1 1/4	NPT	41	62	MALLEABLE IRON	4 LUG TYPE
2303373	I9A9K328-041049	1 1/2	NPT	41	62	MALLEABLE IRON	4 LUG TYPE
2303374	I9A9K328-041060	2	NPT	41	62	MALLEABLE IRON	4 LUG TYPE
2306787	I3A9K328-041021	1/2	NPT	41	62	S/S 316	
2306788	I3A9K328-041027	3/4	NPT	41	62	S/S 316	
2306789	I3A9K328-041034	1	NPT	41	62	S/S 316	

## TYPE B CLAW COUPLING (U.S. TYPE)

Blank cap



Item Code	Part Number	Claw Distance Internal mm	Claw Distance External mm	Material
2303362	I9A9K400-041000	41	62	MALLEABLE IRON
2306790	I3A9K400-041000	41	62	S/S 316

## TYPE B CLAW COUPLING (U.S. TYPE)

Safety pin



Item Code	Part Number	Material
2303232	I1YC4001	PLATED STEEL

## TYPE B CLAW COUPLING (U.S. TYPE)

Claw clamps



Item Code	Part Number	Hose ID in	Hose ID mm	Hose OD min mm	Hose OD max mm	Material
2302928	I9LG2B-013028	1/2	13	25,0	30,0	MALLEABLE IRON
2302929	I9LG2B-019031	3/4	19	30,0	33,0	MALLEABLE IRON
2302930	I9LG2B-025042	1	25	35,0	45,0	MALLEABLE IRON

## CRIMPING RING



Item Code	Part Number	Hose ID mm	Ring ID mm	Ring OD mm	Ring L mm	Material
2303033	R5YBFF0-0242020	13	24	28	20	ALUMINIUM
2303034	R5YBFF0-0312020	19	31	35	20	ALUMINIUM
2303035	R5YBFF0-0402520	25	40	45	20	ALUMINIUM
2306680	R5YBFF0-0552530	45	55	60	30	ALUMINIUM
2304550	R5YBFF0-0602535	45	60	65	35	ALUMINIUM
2304551	R5YBFF0-0902540	70-76	90	95	40	ALUMINIUM
2303040	R5YBFF0-1102560	90	110	115	60	ALUMINIUM
2304552	R5YBFF0-1252580	102-105-110	125	130	80	ALUMINIUM

## TYPE B CLAW COUPLING (U.S. TYPE)

Hose shank with Precrimped ferrule - Gasket Included



Item Code	Part Number	Hose ID in	Hose ID mm	Claw Distance Internal mm	Claw Distance External mm	Hose OD min-MAX mm	Material
2306783	I319KL00-019041	3/4	19	41	62	26,9 - 34,1	S/S 316

## GROUND JOINT SEAL

Complete coupling BSP



Item Code	Part Number	Hose ID in	Hose ID mm	Thread in	Thread Type	Material
2302966	I918B206-013021	1/2	13	1/2	BSP	MALLEABLE IRON
2302967	I918B206-019027	3/4	19	3/4	BSP	MALLEABLE IRON
2302968	I918B206-025034	1	25	1	BSP	MALLEABLE IRON
2302969	I918B206-032042	1 1/4	32	1 1/4	BSP	MALLEABLE IRON
2302970	I918B206-038049	1 1/2	38	1 1/2	BSP	MALLEABLE IRON
2302971	I918B206-051060	2	51	2	BSP	MALLEABLE IRON
2302972	I918B206-063076	2 1/2	63	2 1/2	BSP	MALLEABLE IRON
2302973	I918B206-076090	3	76	3	BSP	MALLEABLE IRON
2302974	I918B206-102114	4	102	4	BSP	MALLEABLE IRON

## GROUND JOINT SEAL

Complete coupling NPT



Item Code	Part Number	Hose ID in	Hose ID mm	Thread in	Thread Type	Material
2303386	I918B228-013021	1/2	13	1/2	NPT	MALLEABLE IRON
2303387	I918B228-019027	3/4	19	3/4	NPT	MALLEABLE IRON
2303388	I918B228-025034	1	25	1	NPT	MALLEABLE IRON
2303389	I918B228-032042	1 1/4	32	1 1/4	NPT	MALLEABLE IRON
2303390	I918B228-038049	1 1/2	38	1 1/2	NPT	MALLEABLE IRON
2303391	I918B228-051060	2	51	2	NPT	MALLEABLE IRON
2303392	I918B228-063076	2 1/2	63	2 1/2	NPT	MALLEABLE IRON
2303393	I918B228-076090	3	76	3	NPT	MALLEABLE IRON
2303394	I918B228-102114	4	102	4	NPT	MALLEABLE IRON

## GROUND JOINT SEAL

Male BSP - Hose shank



Item Code	Part Number	Hose ID in	Hose ID mm	Thread in	Thread Type	Material
2302983	I118B107-013021	1/2	13	1/2	BSP	PLATED STEEL
2302984	I118B107-019027	3/4	19	3/4	BSP	PLATED STEEL
2302985	I118B107-025034	1	25	1	BSP	PLATED STEEL
2302986	I918B107-032042	1 1/4	32	1 1/4	BSP	MALLEABLE IRON
2302987	I918B107-038049	1 1/2	38	1 1/2	BSP	MALLEABLE IRON
2302988	I918B107-051060	2	51	2	BSP	MALLEABLE IRON
2302989	I918B107-063076	2 1/2	63	2 1/2	BSP	MALLEABLE IRON
2302990	I918B107-076090	3	76	3	BSP	MALLEABLE IRON
2302991	I918B107-102114	4	102	4	BSP	MALLEABLE IRON

## GROUND JOINT SEAL

Male NPT - Hose shank



Item Code	Part Number	Hose ID in	Hose ID mm	Thread in	Thread Type	Material
2303428	I918B128-013021	1/2	13	1/2	NPT	MALLEABLE IRON
2303429	I918B128-019027	3/4	19	3/4	NPT	MALLEABLE IRON
2303430	I918B128-025034	1	25	1	NPT	MALLEABLE IRON
2303431	I918B128-032042	1 1/4	32	1 1/4	NPT	MALLEABLE IRON
2303432	I918B128-038049	1 1/2	38	1 1/2	NPT	MALLEABLE IRON
2303433	I918B128-051060	2	51	2	NPT	MALLEABLE IRON
2303434	I918B128-063076	2 1/2	63	2 1/2	NPT	MALLEABLE IRON
2303435	I918B128-076090	3	76	3	NPT	MALLEABLE IRON
2303436	I918B128-102114	4	102	4	NPT	MALLEABLE IRON

## GROUND JOINT SEAL

Clamps - 2 Bolt - 2 Gripping finger type



Item Code	Part Number	Hose ID in	Hose ID mm	Hose OD Min mm	Hose OD Max mm	Material
2302992	I9LG2F-013026	1/2	13	24	27	MALLEABLE IRON
2302993	I9LG2F-019032	3/4	19	30	33	MALLEABLE IRON
2303440	I9LG2F-019036	3/4	19	33	38	MALLEABLE IRON

## GROUND JOINT SEAL

Clamps - 4 Bolt - 2 Gripping finger type



Item Code	Part Number	Hose ID in	Hose ID mm	Hose OD Min mm	Hose OD Max mm	Material
2303443	I9LG4F-025038	1	25	35,5	40	MALLEABLE IRON
2302994	I9LG4F-025041	1	25	39	43,5	MALLEABLE IRON
2302995 <sup>■</sup>	I9LG4F-032046	1 1/4	32	43	47,5	MALLEABLE IRON
2302996	I9LG4F-038049	1 1/4	32	45	53	MALLEABLE IRON
2303448	I9LG4F-038060	1 1/2	38	55,5	60	MALLEABLE IRON
2302997	I9LG4F-051067	2	51	63	71	MALLEABLE IRON
	I9LG4F-063083	2 1/2	63	78,5	87,5	MALLEABLE IRON
2302998	I9LG4F-076094	3	76	89	100	MALLEABLE IRON

■ 4 GRIPPING FINGER

## GROUND JOINT SEAL

Clamps - 6 Bolt - 3 Gripping finger type



Item Code	Part Number	Hose ID in	Hose ID mm	Hose OD Min mm	Hose OD Max mm	Material
2302999	I9LG6F-102123	4	102	117,5	127	MALLEABLE IRON
	I9LG6F-102142	4	102	133,5	142	MALLEABLE IRON

## CAM & GROOVE MIL C - 27.487

Type A - Adapter, female BSP



Item Code	Part Number	Thread in	Thread type	Head DN in	Head DN mm	Material
2303234	I5A9C606-013021	1/2	BSP	1/2	13	ALUMINIUM
2301830	I5A9C606-019027	3/4	BSP	3/4	19	ALUMINIUM
2300182	I5A9C606-025034	1	BSP	1	25	ALUMINIUM
2300183	I5A9C606-032042	1 1/4	BSP	1 1/4	32	ALUMINIUM
2301831	I5A9C606-038049	1 1/2	BSP	1 1/2	38	ALUMINIUM
2301832	I5A9C606-051060	2	BSP	2	51	ALUMINIUM
2301833	I5A9C606-063076	2 1/2	BSP	2 1/2	63	ALUMINIUM
2301834	I5A9C606-076090	3	BSP	3	76	ALUMINIUM
2301835	I5A9C606-102114	4	BSP	4	102	ALUMINIUM
2302706	I5A9C606-127140	5	BSP	5	127	ALUMINIUM
2301836	I5A9C606-152165	6	BSP	6	152	ALUMINIUM



Item Code	Part Number	Thread in	Thread type	Head DN in	Head DN mm	Material
2303236	I3A9C606-013021	1/2	BSP	1/2	13	S/S 316
2301837	I3A9C606-019027	3/4	BSP	3/4	19	S/S 316
2300148	I3A9C606-025034	1	BSP	1	25	S/S 316
2300149	I3A9C606-032042	1 1/4	BSP	1 1/4	32	S/S 316
2301838	I3A9C606-038049	1 1/2	BSP	1 1/2	38	S/S 316
2301839	I3A9C606-051060	2	BSP	2	51	S/S 316
2301840	I3A9C606-063076	2 1/2	BSP	2 1/2	63	S/S 316
2302602	I3A9C606-076090	3	BSP	3	76	S/S 316
2302603	I3A9C606-102114	4	BSP	4	102	S/S 316
2302604	I3A9C606-152165	6	BSP	6	152	S/S 316



Item Code	Part Number	Thread in	Thread type	Head DN in	Head DN mm	Material
2303235	I8A9C606-013021	1/2	BSP	1/2	13	BRASS
2301841	I8A9C606-019027	3/4	BSP	3/4	19	BRASS
2301842	I8A9C606-025034	1	BSP	1	25	BRASS
2302789	I8A9C606-032042	1 1/4	BSP	1 1/4	32	BRASS
2302790	I8A9C606-038049	1 1/2	BSP	1 1/2	38	BRASS
2301843	I8A9C606-051060	2	BSP	2	51	BRASS
2301844	I8A9C606-063076	2 1/2	BSP	2 1/2	63	BRASS
2301845	I8A9C606-076090	3	BSP	3	76	BRASS
2301846	I8A9C606-102114	4	BSP	4	102	BRASS



Item Code	Part Number	Thread in	Thread type	Head DN in	Head DN mm	Material
2303259	IPA9C606-013021	1/2	BSP	1/2	13	PP
2303260	IPA9C606-019027	3/4	BSP	3/4	19	PP
2303261	IPA9C606-025034	1	BSP	1	25	PP
2303262	IPA9C606-032042	1 1/4	BSP	1 1/4	32	PP
2303263	IPA9C606-038049	1 1/2	BSP	1 1/2	38	PP
2303264	IPA9C606-051060	2	BSP	2	51	PP
2303266	IPA9C606-076090	3	BSP	3	76	PP
2303267	IPA9C606-102114	4	BSP	4	102	PP

## CAM & GROOVE MIL C - 27.487

### Type A - Adapter, female NPT



Item Code	Part Number	Thread in	Thread type	Head DN in	Head DN mm	Material
2303469	I5A9C628-013021	1/2	NPT	1/2	13	ALUMINIUM
2303470	I5A9C628-019027	3/4	NPT	3/4	19	ALUMINIUM
2303471	I5A9C628-025034	1	NPT	1	25	ALUMINIUM
2303472	I5A9C628-032042	1 1/4	NPT	1 1/4	32	ALUMINIUM
2303473	I5A9C628-038049	1 1/2	NPT	1 1/2	38	ALUMINIUM
2303474	I5A9C628-051060	2	NPT	2	51	ALUMINIUM
2303475	I5A9C628-063076	2 1/2	NPT	2 1/2	63	ALUMINIUM
2303476	I5A9C628-076090	3	NPT	3	76	ALUMINIUM
2303477	I5A9C628-102114	4	NPT	4	102	ALUMINIUM
2303478	I5A9C628-127140	5	NPT	5	127	ALUMINIUM
2303479	I5A9C628-152165	6	NPT	6	152	ALUMINIUM
2303480	I5A9C628-203219	8	NPT	8	203	ALUMINIUM



Item Code	Part Number	Thread in	Thread type	Head DN in	Head DN mm	Material
2303492	I3A9C628-013021	1/2	NPT	1/2	13	S/S 316
2303493	I3A9C628-019027	3/4	NPT	3/4	19	S/S 316
2303494	I3A9C628-025034	1	NPT	1	25	S/S 316
2303495	I3A9C628-032042	1 1/4	NPT	1 1/4	32	S/S 316
2303496	I3A9C628-038049	1 1/2	NPT	1 1/2	38	S/S 316
2303497	I3A9C628-051060	2	NPT	2	51	S/S 316
2303498	I3A9C628-063076	2 1/2	NPT	2 1/2	63	S/S 316
2303499	I3A9C628-076090	3	NPT	3	76	S/S 316
2303500	I3A9C628-102114	4	NPT	4	102	S/S 316
2303501	I3A9C628-127140	5	NPT	5	127	S/S 316
2303502	I3A9C628-152165	6	NPT	6	152	S/S 316
2303503	I3A9C628-203219	8	NPT	8	203	S/S 316



Item Code	Part Number	Thread in	Thread type	Head DN in	Head DN mm	Material
2303481	I8A9C628-013021	1/2	NPT	1/2	13	BRASS
2303482	I8A9C628-019027	3/4	NPT	3/4	19	BRASS
2303483	I8A9C628-025034	1	NPT	1	25	BRASS
2303484	I8A9C628-032042	1 1/4	NPT	1 1/4	32	BRASS
2303485	I8A9C628-038049	1 1/2	NPT	1 1/2	38	BRASS
2303486	I8A9C628-051060	2	NPT	2	51	BRASS
2303487	I8A9C628-063076	2 1/2	NPT	2 1/2	63	BRASS
2303488	I8A9C628-076090	3	NPT	3	76	BRASS
2303489	I8A9C628-102114	4	NPT	4	102	BRASS
2303490	I8A9C628-127140	5	NPT	5	127	BRASS
2303491	I8A9C628-152165	6	NPT	6	152	BRASS



Item Code	Part Number	Thread in	Thread type	Head DN in	Head DN mm	Material
2303504	IPA9C628-013021	1/2	NPT	1/2	13	PP
2303505	IPA9C628-019027	3/4	NPT	3/4	19	PP
2303506	IPA9C628-025034	1	NPT	1	25	PP
2303507	IPA9C628-032042	1 1/4	NPT	1 1/4	32	PP
2303508	IPA9C628-038049	1 1/2	NPT	1 1/2	38	PP
2303509	IPA9C628-051060	2	NPT	2	51	PP
2303511	IPA9C628-076090	3	NPT	3	76	PP
2303512	IPA9C628-102114	4	NPT	4	102	PP

# Cam & Groove

## CAM & GROOVE MIL C - 27.487

Type D - Coupler, female BSP



Item Code	Part Number	Thread in	Thread type	Head DN in	Head DN mm	Material
2303245	I5A9C806-013021	1/2	BSP	1/2	13	ALUMINIUM
2301876	I5A9C806-019027	3/4	BSP	3/4	19	ALUMINIUM
2300193	I5A9C806-025034	1	BSP	1	25	ALUMINIUM
2300194	I5A9C806-032042	1 1/4	BSP	1 1/4	32	ALUMINIUM
2301877	I5A9C806-038049	1 1/2	BSP	1 1/2	38	ALUMINIUM
2301878	I5A9C806-051060	2	BSP	2	51	ALUMINIUM
2301879	I5A9C806-063076	2 1/2	BSP	2 1/2	63	ALUMINIUM
2301880	I5A9C806-076090	3	BSP	3	76	ALUMINIUM
2301881	I5A9C806-102114	4	BSP	4	102	ALUMINIUM
2302711	I5A9C806-127140	5	BSP	5	127	ALUMINIUM
2301882	I5A9C806-152165	6	BSP	6	152	ALUMINIUM



Item Code	Part Number	Thread in	Thread type	Head DN in	Head DN mm	Material
2303247	I3A9C806-013021	1/2	BSP	1/2	13	S/S 316
2301883	I3A9C806-019027	3/4	BSP	3/4	19	S/S 316
2300155	I3A9C806-025034	1	BSP	1	25	S/S 316
2300156	I3A9C806-032042	1 1/4	BSP	1 1/4	32	S/S 316
2301884	I3A9C806-038049	1 1/2	BSP	1 1/2	38	S/S 316
2301885	I3A9C806-051060	2	BSP	2	51	S/S 316
2301886	I3A9C806-063076	2 1/2	BSP	2 1/2	63	S/S 316
2301887	I3A9C806-076090	3	BSP	3	76	S/S 316
2302224	I3A9C806-102114	4	BSP	4	102	S/S 316
2302611	I3A9C806-152165	6	BSP	6	152	S/S 316



Item Code	Part Number	Thread in	Thread type	Head DN in	Head DN mm	Material
2304806	I8A9C806-013021	1/2	BSP	1/2	13	BRASS
2301888	I8A9C806-019027	3/4	BSP	3/4	19	BRASS
2301889	I8A9C806-025034	1	BSP	1	25	BRASS
2301890	I8A9C806-032042	1 1/4	BSP	1 1/4	32	BRASS
2301891	I8A9C806-038049	1 1/2	BSP	1 1/2	38	BRASS
2301892	I8A9C806-051060	2	BSP	2	51	BRASS
2301893	I8A9C806-063076	2 1/2	BSP	2 1/2	63	BRASS
2301894	I8A9C806-076090	3	BSP	3	76	BRASS
2301895	I8A9C806-102114	4	BSP	4	102	BRASS



Item Code	Part Number	Thread in	Thread type	Head DN in	Head DN mm	Material
2303286	IPA9C806-013021	1/2	BSP	1/2	13	PP
2303287	IPA9C806-019027	1/4	BSP	1/4	19	PP
2303288	IPA9C806-025034	1	BSP	1	25	PP
2303289	IPA9C806-032042	1 1/4	BSP	1 1/4	32	PP
2303290	IPA9C806-038049	1 1/2	BSP	1 1/2	38	PP
2303291	IPA9C806-051060	2	BSP	2	51	PP
2303293	IPA9C806-076090	3	BSP	3	76	PP
2303294	IPA9C806-102114	4	BSP	4	102	PP

hose fittings accessories



## CAM & GROOVE MIL C - 27.487

### Type D - Coupler, female NPT



Item Code	Part Number	Thread in	Thread type	Head DN in	Head DN mm	Material
2303626	I5A9C828-013021	1/2	NPT	1/2	13	ALUMINIUM
2303627	I5A9C828-019027	3/4	NPT	3/4	19	ALUMINIUM
2303628	I5A9C828-025034	1	NPT	1	25	ALUMINIUM
2303629	I5A9C828-032042	1 1/4	NPT	1 1/4	32	ALUMINIUM
2303630	I5A9C828-038049	1 1/2	NPT	1 1/2	38	ALUMINIUM
2303631	I5A9C828-051060	2	NPT	2	51	ALUMINIUM
2303632	I5A9C828-063076	2 1/2	NPT	2 1/2	63	ALUMINIUM
2303633	I5A9C828-076090	3	NPT	3	76	ALUMINIUM
2303634	I5A9C828-102114	4	NPT	4	102	ALUMINIUM
2303635	I5A9C828-127140	5	NPT	5	127	ALUMINIUM
2303636	I5A9C828-152165	6	NPT	6	152	ALUMINIUM
2303637	I5A9C828-203219	8	NPT	8	203	ALUMINIUM



Item Code	Part Number	Thread in	Thread type	Head DN in	Head DN mm	Material
2303649	I3A9C828-013021	1/2	NPT	1/2	13	S/S 316
2303650	I3A9C828-019027	3/4	NPT	3/4	19	S/S 316
2303651	I3A9C828-025034	1	NPT	1	25	S/S 316
2303652	I3A9C828-032042	1 1/4	NPT	1 1/4	32	S/S 316
2303653	I3A9C828-038049	1 1/2	NPT	1 1/2	38	S/S 316
2303654	I3A9C828-051060	2	NPT	2	51	S/S 316
2303655	I3A9C828-063076	2 1/2	NPT	2 1/2	63	S/S 316
2303656	I3A9C828-076090	3	NPT	3	76	S/S 316
2303657	I3A9C828-102114	4	NPT	4	102	S/S 316
2303658	I3A9C828-127140	5	NPT	5	127	S/S 316
2303659	I3A9C828-152165	6	NPT	6	152	S/S 316



Item Code	Part Number	Thread in	Thread type	Head DN in	Head DN mm	Material
2303638	I8A9C828-013021	1/2	NPT	1/2	13	BRASS
2303639	I8A9C828-019027	3/4	NPT	3/4	19	BRASS
2303640	I8A9C828-025034	1	NPT	1	25	BRASS
2303641	I8A9C828-032042	1 1/4	NPT	1 1/4	32	BRASS
2303642	I8A9C828-038049	1 1/2	NPT	1 1/2	38	BRASS
2303643	I8A9C828-051060	2	NPT	2	51	BRASS
2303644	I8A9C828-063076	2 1/2	NPT	2 1/2	63	BRASS
2303645	I8A9C828-076090	3	NPT	3	76	BRASS
2303646	I8A9C828-102114	4	NPT	4	102	BRASS
2303647	I8A9C828-127140	5	NPT	5	127	BRASS
2303648	I8A9C828-152165	6	NPT	6	152	BRASS



Item Code	Part Number	Thread in	Thread type	Head DN in	Head DN mm	Material
2303660	IPA9C828-013021	1/2	NPT	1/2	13	PP
2303661	IPA9C828-019027	1/4	NPT	1/4	19	PP
2303662	IPA9C828-025034	1	NPT	1	25	PP
2303663	IPA9C828-032042	1 1/4	NPT	1 1/4	32	PP
2303664	IPA9C828-038049	1 1/2	NPT	1 1/2	38	PP
2303665	IPA9C828-051060	2	NPT	2	51	PP
2303667	IPA9C828-076090	3	NPT	3	76	PP
2303668	IPA9C828-102114	4	NPT	4	102	PP

## CAM & GROOVE MIL C - 27.487

Type DC - Female dust cap for adapter



Item Code	Part Number	Head DN in	Head DN mm	Material
2303254	I5A9C900-013	1/2	13	ALUMINIUM
2301967	I5A9C900-019	3/4	19	ALUMINIUM
2300200	I5A9C900-025	1	25	ALUMINIUM
2300201	I5A9C900-032	1 1/4	32	ALUMINIUM
2301968	I5A9C900-038	1 1/2	38	ALUMINIUM
2301969	I5A9C900-051	2	51	ALUMINIUM
2301970	I5A9C900-063	2 1/2	63	ALUMINIUM
2301971	I5A9C900-076	3	76	ALUMINIUM
2301972	I5A9C900-102	4	102	ALUMINIUM
2302712	I5A9C900-127	5	127	ALUMINIUM
2302713	I5A9C900-152	6	152	ALUMINIUM
2303756	I5A9C900-203	8	203	ALUMINIUM



Item Code	Part Number	Head DN in	Head DN mm	Material
2303256	I3A9C900-013	1/2	13	S/S 316
2301973	I3A9C900-019	3/4	19	S/S 316
2301546	I3A9C900-025	1	25	S/S 316
2302612	I3A9C900-032	1 1/4	32	S/S 316
2302613	I3A9C900-038	1 1/2	38	S/S 316
2302225	I3A9C900-051	2	51	S/S 316
2302614	I3A9C900-063	2 1/2	63	S/S 316
2302615	I3A9C900-076	3	76	S/S 316
2302616	I3A9C900-102	4	102	S/S 316
2303761	I3A9C900-127	5	127	S/S 316
2302617	I3A9C900-152	6	152	S/S 316



Item Code	Part Number	Head DN in	Head DN mm	Material
2303255	I8A9C900-013	1/2	13	BRASS
2302797	I8A9C900-019	3/4	19	BRASS
2302798	I8A9C900-025	1	25	BRASS
2302799	I8A9C900-032	1 1/4	32	BRASS
2302800	I8A9C900-038	1 1/2	38	BRASS
2302226	I8A9C900-051	2	51	BRASS
2302801	I8A9C900-063	2 1/2	63	BRASS
2302227	I8A9C900-076	3	76	BRASS
2302802	I8A9C900-102	4	102	BRASS
2303758	I8A9C900-127	5	127	BRASS
2303759	I8A9C900-152	6	152	BRASS



Item Code	Part Number	Head DN in	Head DN mm	Material
2303313	IPA9C900-013	1/2	13	PP
2303314	IPA9C900-019	3/4	19	PP
2303315	IPA9C900-025	1	25	PP
2303316	IPA9C900-032	1 1/4	32	PP
2303317	IPA9C900-038	1 1/2	38	PP
2303318	IPA9C900-051	2	51	PP
2303320	IPA9C900-076	3	76	PP
2303321	IPA9C900-102	4	102	PP

## CAM & GROOVE MIL C - 27.487

Type DP - Male dust plug for coupler



Item Code	Part Number	Head DN in	Head DN mm	Material
2303257	I5A9C700-013	1/2	13	ALUMINIUM
2301979	I5A9C700-019	3/4	19	ALUMINIUM
2300967	I5A9C700-025	1	25	ALUMINIUM
2302707	I5A9C700-032	1 1/4	32	ALUMINIUM
2301982	I5A9C700-038	1 1/2	38	ALUMINIUM
2301983	I5A9C700-051	2	51	ALUMINIUM
2301985	I5A9C700-063	2 1/2	63	ALUMINIUM
2301986	I5A9C700-076	3	76	ALUMINIUM
2302708	I5A9C700-102	4	102	ALUMINIUM
2302709	I5A9C700-127	5	127	ALUMINIUM
2301988	I5A9C700-152	6	152	ALUMINIUM



Item Code	Part Number	Head DN in	Head DN mm	Material
2303237	I3A9C700-013	1/2	13	S/S 316
2302605	I3A9C700-019	3/4	19	S/S 316
2302606	I3A9C700-025	1	25	S/S 316
2302607	I3A9C700-032	1 1/4	32	S/S 316
2301746	I3A9C700-038	1 1/2	38	S/S 316
2302608	I3A9C700-051	2	51	S/S 316
2301989	I3A9C700-063	2 1/2	63	S/S 316
2301747	I3A9C700-076	3	76	S/S 316
2302609	I3A9C700-102	4	102	S/S 316
2302610	I3A9C700-152	6	152	S/S 316



Item Code	Part Number	Head DN in	Head DN mm	Material
2303258	I8A9C700-013	1/2	13	BRASS
2302792	I8A9C700-019	3/4	19	BRASS
2302793	I8A9C700-025	1	25	BRASS
2302794	I8A9C700-032	1 1/4	32	BRASS
2302795	I8A9C700-038	1 1/2	38	BRASS
2302228	I8A9C700-051	2	51	BRASS
2302229	I8A9C700-063	2 1/2	63	BRASS
2302230	I8A9C700-076	3	76	BRASS
2302231	I8A9C700-102	4	102	BRASS
2302796	I8A9C700-127	5	127	BRASS
2303782	I8A9C700-152	6	152	BRASS



Item Code	Part Number	Head DN in	Head DN mm	Material
2303322	IPA9C700-013	1/2	13	PP
2303323	IPA9C700-019	3/4	19	PP
2303324	IPA9C700-025	1	25	PP
2303325	IPA9C700-032	1 1/4	32	PP
2303326	IPA9C700-038	1 1/2	38	PP
2303327	IPA9C700-051	2	51	PP
2303329	IPA9C700-076	3	76	PP
2303330	IPA9C700-102	4	102	PP

## COMBINATION NIPPLE

Male NPT complete with pre-crimped ferrule - heavy duty

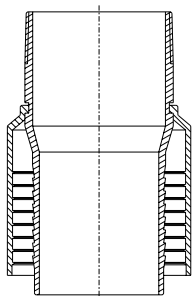

Item Code	Part Number	Hose ID in	Hose ID mm	Thread in	Thread type	Hose OD min-MAX mm	Material
2302332	I1728M00-076090	3	76	3	NPT	88-102	PLATED STEEL
2302333	I1728M00-102114	4	102	4	NPT	114-128	PLATED STEEL
2302334	I1728M00-127140	5	127	5	NPT	139-153	PLATED STEEL
2302335	I1728M00-152165	6	152	6	NPT	166-184	PLATED STEEL

Stainless Steel version available on request

FOR MALE NPT FITTING DN<76mm, PLEASE REFER TO HYDRAULIC RANGE H1212810, RECOMMENDED WITH HYDRAULIC FERRULE H1200203

## COMBINATION NIPPLE

Male BSPT complete with pre-crimped ferrule - heavy duty

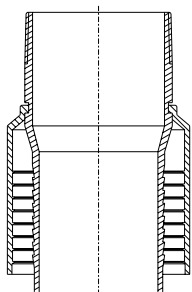

Item Code	Part Number	Hose ID in	Hose ID mm	Thread in	Thread type	Hose OD min-MAX mm	Material
2302324	I1707M00-076090	3	76	3	BSPT	88-102	PLATED STEEL
2302325	I1707M00-102114	4	102	4	BSPT	114-128	PLATED STEEL
2302326	I1707M00-127140	5	127	5	BSPT	139-153	PLATED STEEL
2302007	I1707M00-152165	6	152	6	BSPT	166-184	PLATED STEEL

Stainless Steel version available on request

FOR MALE BSPT FITTING DN<76mm, PLEASE REFER TO HYDRAULIC RANGE H1210710, RECOMMENDED WITH HYDRAULIC FERRULE H1200203

## COMBINATION NIPPLE

Hose mender

FOR DN<76 mm PLEASE REFER TO HYDRAULIC RANGE.

FOR HIGHER DIAMETERS, HOSE MENDERS WITH PRE-CRIMPED FERRULE ARE AVAILABLE ON REQUEST.

## HAMMER LUG UNION - FIG. 100

### NPT Threaded - 3 Pieces (female/male/nut)

**Colour:** Black nut, yellow subs

**Use:** Recommended for air, water and oil services up to 1000 psi in manifold and line connections

**Sealing:** Metal to metal sealing surface

**Pressure (cold working):** 1.000 psi



Item Code	Part Number	NPT Thread in	Material
2306831	I1TC66C6-051051	2	ASTM A-105 Forged Carbon Steel
2306830	I1TC66C6-076076	3	ASTM A-105 Forged Carbon Steel
2303955	I1TC66C6-102102	4	ASTM A-105 Forged Carbon Steel
2303956	I1TC66C6-127127	5	ASTM A-105 Forged Carbon Steel
2303957	I1TC66C6-152152	6	ASTM A-105 Forged Carbon Steel

## HAMMER LUG UNION - FIG. 200

### NPT Threaded - 3 Pieces (female/male/nut)

**Colour:** Blue nut, grey subs

**Use:** Recommended for air, water and oil services up to 2000 psi in manifold and line connections

**Sealing:** Metal to metal sealing surface

**Pressure (cold working):** 2.000 psi



Item Code	Part Number	NPT Thread in	Material
2303958	I1TC96C9-051051	2	ASTM A-105 Forged Carbon Steel
2306567	I1TC96C9-076076	3	ASTM A-105 Forged Carbon Steel
2306568	I1TC96C9-102102	4	ASTM A-105 Forged Carbon Steel
2306569	I1TC96C9-152152	6	ASTM A-105 Forged Carbon Steel

## HAMMER LUG UNION - FIG. 602

### NPT Threaded - 3 Pieces (female/male/nut)

**Colour:** Black nut, orange subs

**Use:** Recommended for water, oil, gas and mud services up to 6000 psi

**Sealing:** Replaceable, Lip type rubber seal provides primary sealing

**Pressure (cold working):** 6.000 psi



Item Code	Part Number	NPT Thread in	Material
2306573	I1TE26E2-025025	1	Alloy Steel AISI 1040
2306832	I1TE26E2-051051	2	Alloy Steel AISI 1040
2306834	I1TE26E2-076076	3	Alloy Steel AISI 1040
2306833	I1TE26E2-102102	4	Alloy Steel AISI 1040

## HAMMER LUG UNION - FIG. 1502

### NPT Threaded - 3 Pieces (female/male/nut)

**Colour:** Blue nut, red subs

**Use:** Recommended for cementing, acidizing, fracturing, testing and choke and kill lines

**Sealing:** Replaceable Lip type rubber seal

**Pressure (cold working):** 15.000 psi



Item Code	Part Number	NPT Thread in	Material
2306257	I1TE16E1-051051	2	Alloy Steel AISI 4130
2306899	I1TE16E1-076076	3	Alloy Steel AISI 4130
2306900	I1TE16E1-102102	4	Alloy Steel AISI 4130

## DRY DISCONNECT COUPLING

Alfagomma offers a wide range of dry disconnect couplings.

Major offshore exploration, chemical and petro chemical companies rely on dry-disconnect couplings to safely transfer their most aggressive, hazardous or valuable liquids.

Designed for safety and ease of use with minimum operator intervention, the self sealing design of the couplings guarantees both the maximum level of safety and the fastest way of connecting-disconnecting.

The installation of dry-disconnect couplings can transform your operation by offering the following benefits:

- Accidental spillage eliminated
- Time saving, no need to drain hoses or pipe systems
- Reduces the possibility of human error in transfer operations
- Improves efficiency

### 2" Dry-Disconnect

**Dimensions:** DN40 - DN50, Ø70 mm

**Materials:** Aluminium alloy, Stainless Steel, brass, Hastelloy, others on request

**Seals:** A full range of elastomeric seals available.

**Connections:** BSP, NPT, Flanged

2" coupling size probably covers the most diverse selection of applications.

Available in a range of material and connection configurations, dry-disconnect 2" coupling is designed for quick and safe transfers. Offshore chemical dosing and aggressive chemical vapour transfer are just some of the challenging applications these couplings are designed for.



### 4" Dry-Disconnect

**Dimensions:** DN 100, ø 164 mm

**Materials:** Aluminium alloy, Stainless Steel, brass, Hastelloy, others on request

**Seals:** A full range of elastomeric seals available.

**Connections:** BSP, NPT, Flanged

4" coupling is extensively used for offshore ship to rig transfers of fuels and drinking water, aviation fuel bunkering, rail tank loading/discharge, chemicals etc.

Fast, positive connection and disconnection make dry-disconnect 4" coupling the standard for barge to ferry re-fuelling and multiple rail tank discharge.



### 6" Dry-Disconnect

**Dimensions:** DN 150, ø 238 mm

**Materials:** Aluminium alloy, Stainless Steel, brass, Hastelloy, others on request

**Seals:** A full range of elastomeric seals available.

**Connections:** BSP, NPT, Flanged

6" coupling is the ideal ship/barge to shore connection.

Much faster and safer than any flange coupling means not only environmental standards compliance but real turn around time savings.

Full marine construction with rotating lifting loop as standard.

As with all dry-disconnect couplings, the 6" is equally suitable for flexible hose or loading arm applications.



## SAFETY BREAK-AWAY COUPLING

Safety Break-away couplings are used to prevent pull away accidents: the internal valves will close the flow in both lines and prevent unwanted release of the media.

Marine and offshore applications include, ship to rig fluid transfer, ship to shore and ship to ship transfer, bunkering refueling.

Safety Break-away couplings are available as ANSI/DIN flanges or BSP/NPT threaded, with sizes from 1" (DN25) to 12" (DN300) and 10/16/25 bar working pressure.



## FIXED FLANGE

### Serrated hose shank



Item Code	Part Number	Hose ID in	Hose ID mm	Flange type	Material Hose shank	Material Flange
2302340	I17BD61A-038038	1 1/2	38	PN 16	PLATED STEEL	PLATED STEEL
2302341	I17BD61A-051051	2	51	PN 16	PLATED STEEL	PLATED STEEL
2302011	I17BD61A-063063	2 1/2	63	PN 16	PLATED STEEL	PLATED STEEL
2303002	I17BD61A-075075	3	76	PN 16	PLATED STEEL	PLATED STEEL
2303003	I17BD61A-100100	4	102	PN 16	PLATED STEEL	PLATED STEEL
2303004	I17BD61A-125125	5	127	PN 16	PLATED STEEL	PLATED STEEL
2303005	I17BD61A-150150	6	152	PN 16	PLATED STEEL	PLATED STEEL
2304547	I17BD61A-200200	8	203	PN 16	PLATED STEEL	PLATED STEEL

Stainless Steel version available on request

TO ASSEMBLE THE INSERT, USE AG INDUSTRIAL SERRATED FERRULE (PLATED STEEL AND STAINLESS STEEL)



Item Code	Part Number	Hose ID in	Hose ID mm	Flange type	Material Hose shank	Material Flange
2302353	I17BE67B-038038	1 1/2	38	ASA 150	PLATED STEEL	PLATED STEEL
2302354	I17BE67B-051051	2	51	ASA 150	PLATED STEEL	PLATED STEEL
2302355	I17BE67B-063063	2 1/2	63	ASA 150	PLATED STEEL	PLATED STEEL
2303006	I17BE67B-075075	3	76	ASA 150	PLATED STEEL	PLATED STEEL
2303007	I17BE67B-100100	4	102	ASA 150	PLATED STEEL	PLATED STEEL
2303008	I17BE67B-125125	5	127	ASA 150	PLATED STEEL	PLATED STEEL
2303009	I17BE67B-150150	6	152	ASA 150	PLATED STEEL	PLATED STEEL
	I17BE67B-200200	8	203	ASA 150	PLATED STEEL	PLATED STEEL

Stainless Steel version available on request

TO ASSEMBLE THE INSERT, USE AG INDUSTRIAL SERRATED FERRULE (PLATED STEEL AND STAINLESS STEEL)

## SWIVEL FLANGE

Serrated hose shank



Item Code	Part Number	Hose ID in	Hose ID mm	Flange type	Material Hose shank	Material Flange
2301291	I17BD72A-038038	1 1/2	38	PN 16	PLATED STEEL	PLATED STEEL
2302014	I17BD72A-051051	2	51	PN 16	PLATED STEEL	PLATED STEEL
2301135	I17BD72A-063063	2 1/2	63	PN 16	PLATED STEEL	PLATED STEEL
2301136	I17BD72A-075075	3	76	PN 16	PLATED STEEL	PLATED STEEL
2301137	I17BD72A-100100	4	102	PN 16	PLATED STEEL	PLATED STEEL
2303011	I17BD72A-125125	5	127	PN 16	PLATED STEEL	PLATED STEEL
2301138	I17BD72A-150150	6	152	PN 16	PLATED STEEL	PLATED STEEL
2301166	I17BD72A-200200	8	203	PN 16	PLATED STEEL	PLATED STEEL

TO ASSEMBLE THE INSERT, USE AG INDUSTRIAL SERRATED FERRULE (PLATED STEEL AND STAINLESS STEEL)



Item Code	Part Number	Hose ID in	Hose ID mm	Flange type	Material Hose shank	Material Flange
2304578	I37BD72A-032032	1 1/4	32	PN 16	S/S 316	S/S 316
2306694	I37BD72A-038038	1 1/2	38	PN 16	S/S 316	S/S 316
2302549	I37BD72A-051051	2	51	PN 16	S/S 316	S/S 316
2303010	I37BD72A-063063	2 1/2	63	PN 16	S/S 316	S/S 316
2303012	I37BD72A-075075	3	76	PN 16	S/S 316	S/S 316
2303013	I37BD72A-100100	4	102	PN 16	S/S 316	S/S 316
2306495	I37BD72A-150150	6	152	PN 16	S/S 316	S/S 316

TO ASSEMBLE THE INSERT, USE AG INDUSTRIAL SERRATED FERRULE (PLATED STEEL AND STAINLESS STEEL)



Item Code	Part Number	Hose ID in	Hose ID mm	Flange type	Material Hose shank	Material Flange
2302356	I17BE79A-038038	1 1/2	38	ASA 150	PLATED STEEL	PLATED STEEL
2302357	I17BE79A-051051	2	51	ASA 150	PLATED STEEL	PLATED STEEL
2302358	I17BE79A-063063	2 1/2	63	ASA 150	PLATED STEEL	PLATED STEEL
2303014	I17BE79A-075075	3	76	ASA 150	PLATED STEEL	PLATED STEEL
2303015	I17BE79A-100100	4	102	ASA 150	PLATED STEEL	PLATED STEEL
2303016	I17BE79A-125125	5	127	ASA 150	PLATED STEEL	PLATED STEEL
2303017	I17BE79A-150150	6	152	ASA 150	PLATED STEEL	PLATED STEEL
	I17BE79A-200200	8	203	ASA 150	PLATED STEEL	PLATED STEEL

TO ASSEMBLE THE INSERT, USE AG INDUSTRIAL SERRATED FERRULE (PLATED STEEL AND STAINLESS STEEL)



Item Code	Part Number	Hose ID in	Hose ID mm	Flange type	Material Hose shank	Material Flange
2302552	I37BE79A-051051	2	51	ASA 150	S/S 316	S/S 316
2303018	I37BE79A-063063	2 1/2	63	ASA 150	S/S 316	S/S 316
2303019	I37BE79A-075075	3	76	ASA 150	S/S 316	S/S 316
2303020	I37BE79A-100100	4	102	ASA 150	S/S 316	S/S 316
2304557	I37BE79A-150150	6	152	ASA 150	S/S 316	S/S 316

TO ASSEMBLE THE INSERT, USE AG INDUSTRIAL SERRATED FERRULE (PLATED STEEL AND STAINLESS STEEL)



## BUILT-IN FITTING

These metal fittings are built into the hose ends during manufacturing and form an integral part of the whole assembly. They are chemically bonded into the hose and mechanically secured to the reinforcement plies and to the embedded steel helix, where present.

**Flange material:** Hot deep zinc plated carbon steel

AVAILABLE ON REQUEST:

- Raised Face (RF) or Flat Face (FF) flange
- Flange complete with non sparking brass ring
- Built-in fittings with UNI PN 10/16 flange
- Stainless steel AISI 316 Built-in fittings
- Fittings according to OCIMF



## FIXED FLANGE - WELDING NECK RAISED FACE

ASME B 16.5 ASA 150 Flange Built-in fitting

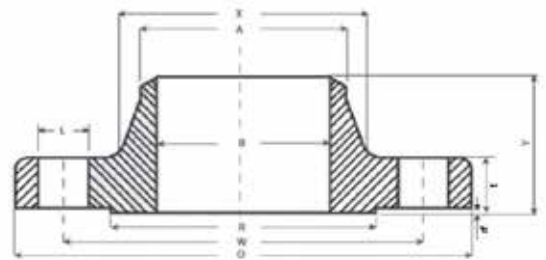

Fittings				Flange									
Item Code	Part Number	Hose ID mm	Flange DN in	O mm	t mm	R mm	X mm	A mm	B mm	Y mm	W mm	Hole n°	L mm
	I1VBE66B-102102	102	4	228,6	23,8	157,2	134,9	114,3	102,4	76,2	190,5	8	19,0
2303980	I1VBE66B-152152	152	6	279,4	25,4	215,9	192,1	168,4	154,2	88,9	241,3	8	22,2
2303948	I1VBE66B-203203	203	8	342,9	28,6	269,8	246,1	219,1	202,7	101,6	298,4	8	22,2
2303949	I1VBE66B-254254	254	10	406,4	30,2	323,8	304,8	273,0	254,5	101,6	361,9	12	25,4
2303950	I1VBE66B-300300	300	12	482,6	31,7	381,0	365,1	323,8	304,8	114,3	431,8	12	25,4

## FIXED FLANGE - SLIP-ON RAISED FACE

ASME B 16.5 ASA 150 Flange Built-in fitting

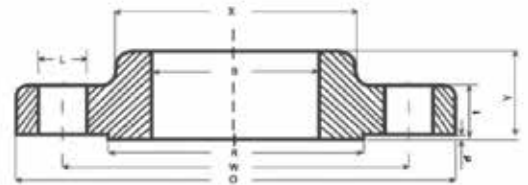

Fittings				Flange									
Item Code	Part Number	Hose ID mm	Flange DN in	O mm	t mm	R mm	X mm	B mm	Y mm	W mm	Hole n°	L mm	
	I1VBE67B-102102	102	4	228,6	23,8	157,2	134,9	116,1	33,3	190,5	8	19,0	
	I1VBE67B-152152	152	6	279,4	25,4	215,9	192,1	170,7	39,7	241,3	8	22,2	
	I1VBE67B-203203	203	8	342,9	28,6	269,8	246,1	221,5	44,4	298,4	8	22,2	
	I1VBE67B-254254	254	10	406,4	30,2	323,8	304,8	276,3	49,2	361,9	12	25,4	
	I1VBE67B-300300	300	12	482,6	31,7	381,0	365,1	327,1	55,6	431,8	12	25,4	

## SWIVEL FLANGE - LAP JOINT

ASME B 16.5 ASA 150 Flange

Built-in fitting



Fittings				Flange									
Item Code	Part Number	Hose ID mm	Flange DN in	O mm	t mm	X mm	B mm	Y mm	r mm	W mm	Hole n°	L mm	
	I1VBE79A-102102	102	4	228,6	23,8	134,9	116,8	33,3	11,1	190,5	8	19,0	
2303983	I1VBE79A-152152	152	6	279,4	25,4	192,1	171,4	39,7	12,7	241,3	8	22,2	
2303951	I1VBE79A-203203	203	8	342,9	28,6	246,1	222,2	44,4	12,7	298,4	8	22,2	
2303952	I1VBE79A-254254	254	10	406,4	30,2	304,8	277,4	49,2	12,7	361,9	12	25,4	
2303984	I1VBE79A-300300	300	12	482,6	31,7	365,1	328,2	55,6	12,7	431,8	12	25,4	

## COMBINATION NIPPLE

Male BSPP - Helical hose shank for composite hose



Item Code	Part Number	Hose ID mm	Thread in	Thread type	Material
2304567	I5206100-025034	25	1	BSPP	ALUMINIUM
2300740	I5206100-040049	40	1 1/2	BSPP	ALUMINIUM
2300741	I5206100-050060	50	2	BSPP	ALUMINIUM
2300742	I5206100-065076	65	2 1/2	BSPP	ALUMINIUM
2300743	I5206100-080090	80	3	BSPP	ALUMINIUM
2300744	I5206100-100114	100	4	BSPP	ALUMINIUM

Item Code	Part Number	Hose ID mm	Thread in	Thread type	Material
	I1206100-150165	150	6	BSPP	PLATED STEEL
	I1206100-200219	200	8	BSPP	PLATED STEEL



Item Code	Part Number	Hose ID mm	Thread in	Thread type	Material
2300729	I3206100-025034	25	1	BSPP	S/S 316
2300730	I3206100-032042	32	1 1/4	BSPP	S/S 316
2300731	I3206100-040049	40	1 1/2	BSPP	S/S 316
2300732	I3206100-050060	50	2	BSPP	S/S 316
2300733	I3206100-065076	65	2 1/2	BSPP	S/S 316
2300734	I3206100-080090	80	3	BSPP	S/S 316
2300735	I3206100-100114	100	4	BSPP	S/S 316
	I3206100-150165	150	6	BSPP	S/S 316
	I3206100-200219	200	8	BSPP	S/S 316



Item Code	Part Number	Hose ID mm	Thread in	Thread type	Material
	I7206100-025034	25	1	BSPP	BRONZE
	I7206100-032042	32	1 1/4	BSPP	BRONZE
	I7206100-040049	40	1 1/2	BSPP	BRONZE
	I7206100-050060	50	2	BSPP	BRONZE
	I7206100-065076	65	2 1/2	BSPP	BRONZE
	I7206100-080090	80	3	BSPP	BRONZE
	I7206100-100114	100	4	BSPP	BRONZE



Item Code	Part Number	Hose ID mm	Thread in	Thread type	Material
2300711	IP206100-040049	40	1 1/2	BSPP	PP
2300712	IP206100-050060	50	2	BSPP	PP
	IP206100-065076	65	2 1/2	BSPP	PP
2300713	IP206100-080090	80	3	BSPP	PP
2300714	IP206100-100114	100	4	BSPP	PP

## COMBINATION NIPPLE

Male NPT - Helical hose shank for composite hose



Item Code	Part Number	Hose ID mm	Thread in	Thread type	Material
	I1228100-050060	50	2	NPT	PLATED STEEL
	I1228100-080090	80	3	NPT	PLATED STEEL
	I1228100-100114	100	4	NPT	PLATED STEEL



Item Code	Part Number	Hose ID mm	Thread in	Thread type	Material
	I3228100-050060	50	2	NPT	S/S 316
	I3228100-080090	80	3	NPT	S/S 316
2306670	I3228100-100114	100	4	NPT	S/S 316

## FIXED FLANGE

Helical hose shank for composite hose



Item Code	Part Number	Hose ID in	Hose ID mm	Flange type	Material Hose Shank	Material flange
2301253	I12BD66B-040040	1 1/2	40	PN 10/16	PLATED STEEL	PLATED STEEL
2301254	I12BD66B-050050	2	50	PN 10/16	PLATED STEEL	PLATED STEEL
2301256	I12BD66B-080080	3	80	PN 10/16	PLATED STEEL	PLATED STEEL
2301257	I12BD66B-100100	4	100	PN 10/16	PLATED STEEL	PLATED STEEL
	I12BD66B-150150	6	150	PN 10/16	PLATED STEEL	PLATED STEEL
	I12BD66B-200200	8	200	PN 10/16	PLATED STEEL	PLATED STEEL
	I12BD66B-250250	10	250	PN 10/16	PLATED STEEL	PLATED STEEL



	I32BD66B-040040	1 1/2	40	PN 10/16	S/S 316	S/S 316
	I32BD66B-050050	2	50	PN 10/16	S/S 316	S/S 316
	I32BD66B-080080	3	80	PN 10/16	S/S 316	S/S 316
2304576	I32BD66B-100100	4	100	PN 10/16	S/S 316	S/S 316
	I32BD66B-150150	6	150	PN 10/16	S/S 316	S/S 316
	I32BD66B-200200	8	200	PN 10/16	S/S 316	S/S 316
	I32BD66B-250250	10	250	PN 10/16	S/S 316	S/S 316



Item Code	Part Number	Hose ID in	Hose ID mm	Flange type	Material Hose Shank	Material flange
	I12BE66B-040040	1 1/2	40	ASA 150	PLATED STEEL	PLATED STEEL
2300062	I12BE66B-050050	2	50	ASA 150	PLATED STEEL	PLATED STEEL
2300064	I12BE66B-080080	3	80	ASA 150	PLATED STEEL	PLATED STEEL
2300065	I12BE66B-100100	4	100	ASA 150	PLATED STEEL	PLATED STEEL
	I12BE66B-150150	6	150	ASA 150	PLATED STEEL	PLATED STEEL
	I12BE66B-200200	8	200	ASA 150	PLATED STEEL	PLATED STEEL
	I12BE66B-250250	10	250	ASA 150	PLATED STEEL	PLATED STEEL



	I32BE66B-040040	1 1/2	40	ASA 150	S/S 316	S/S 316
	I32BE66B-050050	2	50	ASA 150	S/S 316	S/S 316
	I32BE66B-080080	3	80	ASA 150	S/S 316	S/S 316
2301308	I32BE66B-100100	4	100	ASA 150	S/S 316	S/S 316
	I32BE66B-150150	6	150	ASA 150	S/S 316	S/S 316
	I32BE66B-200200	8	200	ASA 150	S/S 316	S/S 316
	I32BE66B-250250	10	250	ASA 150	S/S 316	S/S 316

## SWIVEL FLANGE

Helical hose shank for composite hose



Item Code	Part Number	Hose ID in	Hose ID mm	Flange type	Material Hose Shank	Material flange
2300000	I12BD72A-040040	1 1/2	40	PN 10/16	PLATED STEEL	PLATED STEEL
2300001	I12BD72A-050050	2	50	PN 10/16	PLATED STEEL	PLATED STEEL
2300002	I12BD72A-065065	2 1/2	65	PN 10/16	PLATED STEEL	PLATED STEEL
2300003	I12BD72A-080080	3	80	PN 10/16	PLATED STEEL	PLATED STEEL
2300004	I12BD72A-100100	4	100	PN 10/16	PLATED STEEL	PLATED STEEL
	I12BD72A-150150	6	150	PN 10/16	PLATED STEEL	PLATED STEEL
	I12BD72A-200200	8	200	PN 10/16	PLATED STEEL	PLATED STEEL
	I12BD72A-250250	10	250	PN 10/16	PLATED STEEL	PLATED STEEL



	IA2BD72A-040040	1 1/2	40	PN 10/16	S/S 316	PLATED STEEL
	IA2BD72A-050050	2	50	PN 10/16	S/S 316	PLATED STEEL
	IA2BD72A-080080	3	80	PN 10/16	S/S 316	PLATED STEEL
	IA2BD72A-100100	4	100	PN 10/16	S/S 316	PLATED STEEL
	IA2BD72A-150150	6	150	PN 10/16	S/S 316	PLATED STEEL
	IA2BD72A-200200	8	200	PN 10/16	S/S 316	PLATED STEEL
	IA2BD72A-250250	10	250	PN 10/16	S/S 316	PLATED STEEL



	I32BD72A-040040	1 1/2	40	PN 10/16	S/S 316	S/S 316
	I32BD72A-050050	2	50	PN 10/16	S/S 316	S/S 316
	I32BD72A-080080	3	80	PN 10/16	S/S 316	S/S 316
	I32BD72A-100100	4	100	PN 10/16	S/S 316	S/S 316
	I32BD72A-150150	6	150	PN 10/16	S/S 316	S/S 316
	I32BD72A-200200	8	200	PN 10/16	S/S 316	S/S 316
	I32BD72A-250250	10	250	PN 10/16	S/S 316	S/S 316



Item Code	Part Number	Hose ID in	Hose ID mm	Flange type	Material Hose Shank	Material flange
	IP2BC72A-050050	2	50	PN 10	PP	PP
	IP2BC72A-080080	3	80	PN 10	PP	PP
	IP2BC72A-100100	4	100	PN 10	PP	PP



Item Code	Part Number	Hose ID in	Hose ID mm	Flange type	Material Hose Shank	Material flange
	I12BE77A-040040	1 1/2	40	ASA 150	PLATED STEEL	PLATED STEEL
2300049	I12BE77A-050050	2	50	ASA 150	PLATED STEEL	PLATED STEEL
2300051	I12BE77A-080080	3	80	ASA 150	PLATED STEEL	PLATED STEEL
2300052	I12BE77A-100100	4	100	ASA 150	PLATED STEEL	PLATED STEEL
	I12BE77A-150150	6	150	ASA 150	PLATED STEEL	PLATED STEEL
	I12BE77A-200200	8	200	ASA 150	PLATED STEEL	PLATED STEEL
	I12BE77A-250250	10	250	ASA 150	PLATED STEEL	PLATED STEEL



	IA2BE77A-040040	1 1/2	40	ASA 150	S/S 316	PLATED STEEL
	IA2BE77A-050050	2	50	ASA 150	S/S 316	PLATED STEEL
	IA2BE77A-080080	3	80	ASA 150	S/S 316	PLATED STEEL
	IA2BE77A-100100	4	100	ASA 150	S/S 316	PLATED STEEL
	IA2BE77A-150150	6	150	ASA 150	S/S 316	PLATED STEEL
	IA2BE77A-200200	8	200	ASA 150	S/S 316	PLATED STEEL
	IA2BE77A-250250	10	250	ASA 150	S/S 316	PLATED STEEL



	I32BE77A-040040	1 1/2	40	ASA 150	S/S 316	S/S 316
	I32BE77A-050050	2	50	ASA 150	S/S 316	S/S 316
	I32BE77A-080080	3	80	ASA 150	S/S 316	S/S 316
	I32BE77A-100100	4	100	ASA 150	S/S 316	S/S 316
	I32BE77A-150150	6	150	ASA 150	S/S 316	S/S 316
	I32BE77A-200200	8	200	ASA 150	S/S 316	S/S 316
	I32BE77A-250250	10	250	ASA 150	S/S 316	S/S 316

## SMOOTH FERRULE FOR COMPOSITE HOSE



Item Code	Part Number	Hose ID mm	Material
2304568	I105C5-040	40	PLATED STEEL
2300824	I105C5-050	50	PLATED STEEL
2300896	I105C5-065	65	PLATED STEEL
2300825	I105C5-080	80	PLATED STEEL
2304569	I105C5-100	100	PLATED STEEL
	I105C5-150	150	PLATED STEEL
	I105C5-200	200	PLATED STEEL



Item Code	Part Number	Hose ID mm	Material
2300848	I205C5-025	25	S/S 304
2300849	I205C5-032	32	S/S 304
2300850	I205C5-040	40	S/S 304
2300851	I205C5-050	50	S/S 304
2300852	I205C5-065	65	S/S 304
2300853	I205C5-080	80	S/S 304
2300854	I205C5-100	100	S/S 304
	I205C5-150	150	S/S 304
	I205C5-200	200	S/S 304



Item Code	Part Number	Hose ID mm	Material
2300891	I505C5-040	40	ALUMINIUM
2301751	I505C5-050	50	ALUMINIUM
2300099	I505C5-065	65	ALUMINIUM
2300917	I505C5-080	80	ALUMINIUM
2300892	I505C5-100	100	ALUMINIUM

## CRIMPING GASKET FOR COMPOSITE HOSE



Item Code	Part Number	Hose ID mm	Material
2300484	INJS00-025	25	NBR
2300485	INJS00-032	32	NBR
2300486	INJS00-040	40	NBR
2300487	INJS00-050	50	NBR
2300488	INJS00-065	65	NBR
2300489	INJS00-080	80	NBR
2300490	INJS00-100	100	NBR
	INJS00-150	150	NBR
	INJS00-200	200	NBR

GASKETS IN VITON® ARE AVAILABLE ON REQUEST

